

LEGEND

- WATER LINE
- SANITARY SEWER LINE
- GAS LINE
- STORM SEWER LINE
- (7) AREA OF POTENTIAL CONCERN
- CURRENT GROUNDWATER REMEDIATION AREA
- PROPOSED SOIL BORINGS (APPROXIMATE)

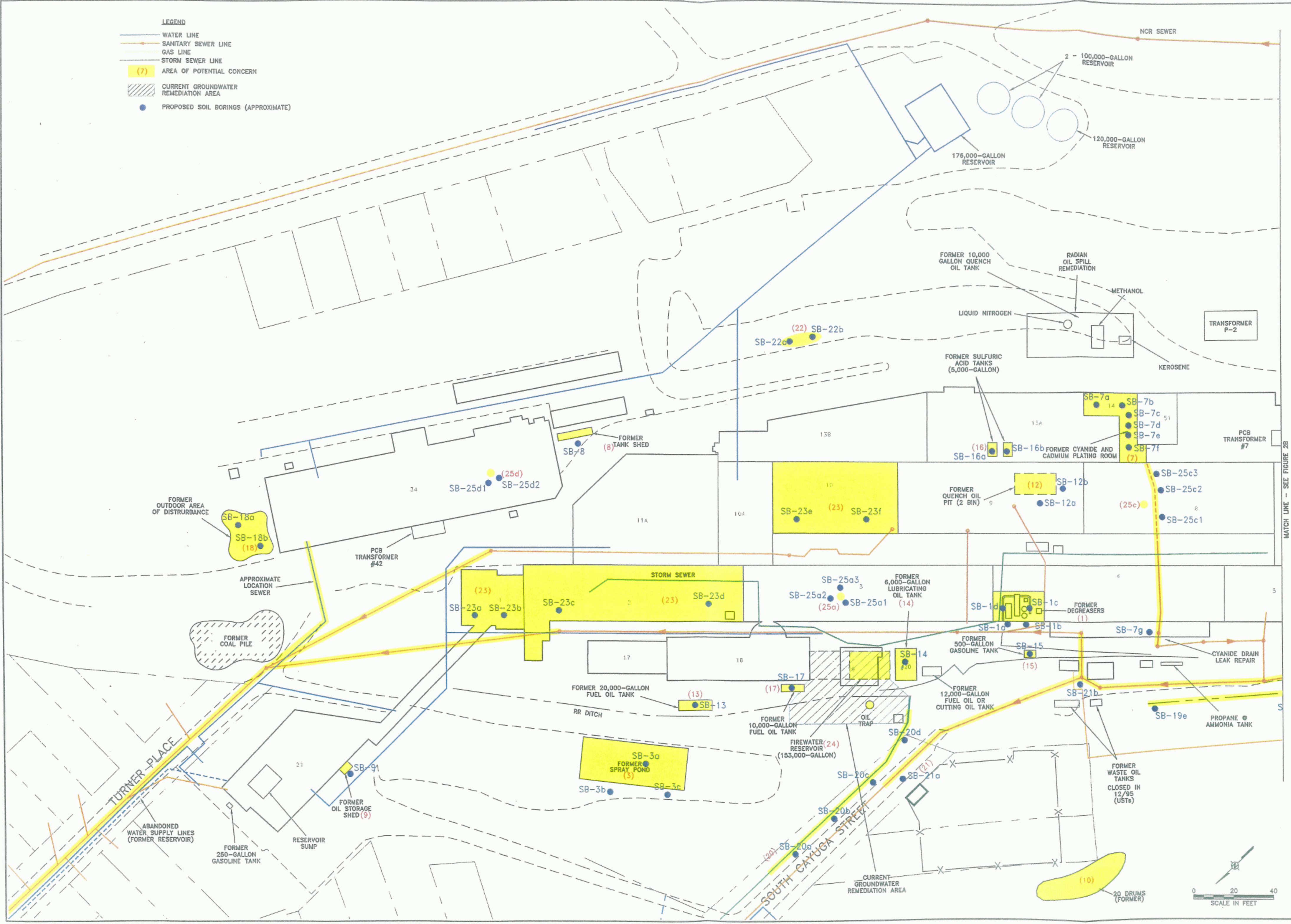

REV	DESCRIPTION	DATE

EGC
 DRAWN BY
 CHECKED
 APPROVED
 PROPERTY OF WSP ENVIRONMENTAL STRATEGIES, LLC. ANY REUSE OR MODIFICATION OF THIS DOCUMENT WITHOUT THE WRITTEN CONSENT OF WSP ENVIRONMENTAL STRATEGIES, LLC IS PROHIBITED. THIS DOCUMENT IS NOT TO BE USED FOR ANY OTHER PROJECT WITHOUT THE WRITTEN CONSENT OF WSP ENVIRONMENTAL STRATEGIES, LLC. NOTICE: THIS DRAWING HAS BEEN PREPARED UNDER THE REGULATION OF STATE LAW AND ANY REVISIONS, UNLESS NOTED OTHERWISE, SHALL BE SUBJECT TO THE SAME REGULATION. ENGINEER TO ACCEPT THIS DOCUMENT IN ANY WAY.

AREAS OF POTENTIAL CONCERN (EASTERN)
EMERSON POWER TRANSMISSION
ITHACA, NEW YORK
 PREPARED FOR
EMERSON POWER TRANSMISSION

WSP
 ENVIRONMENTAL STRATEGIES
 11911 FREEDOM DRIVE SUITE 900
 RESTON, VIRGINIA 20190
 (703) 709-6500

FIGURE 2A
 Drawing Number
 127491139

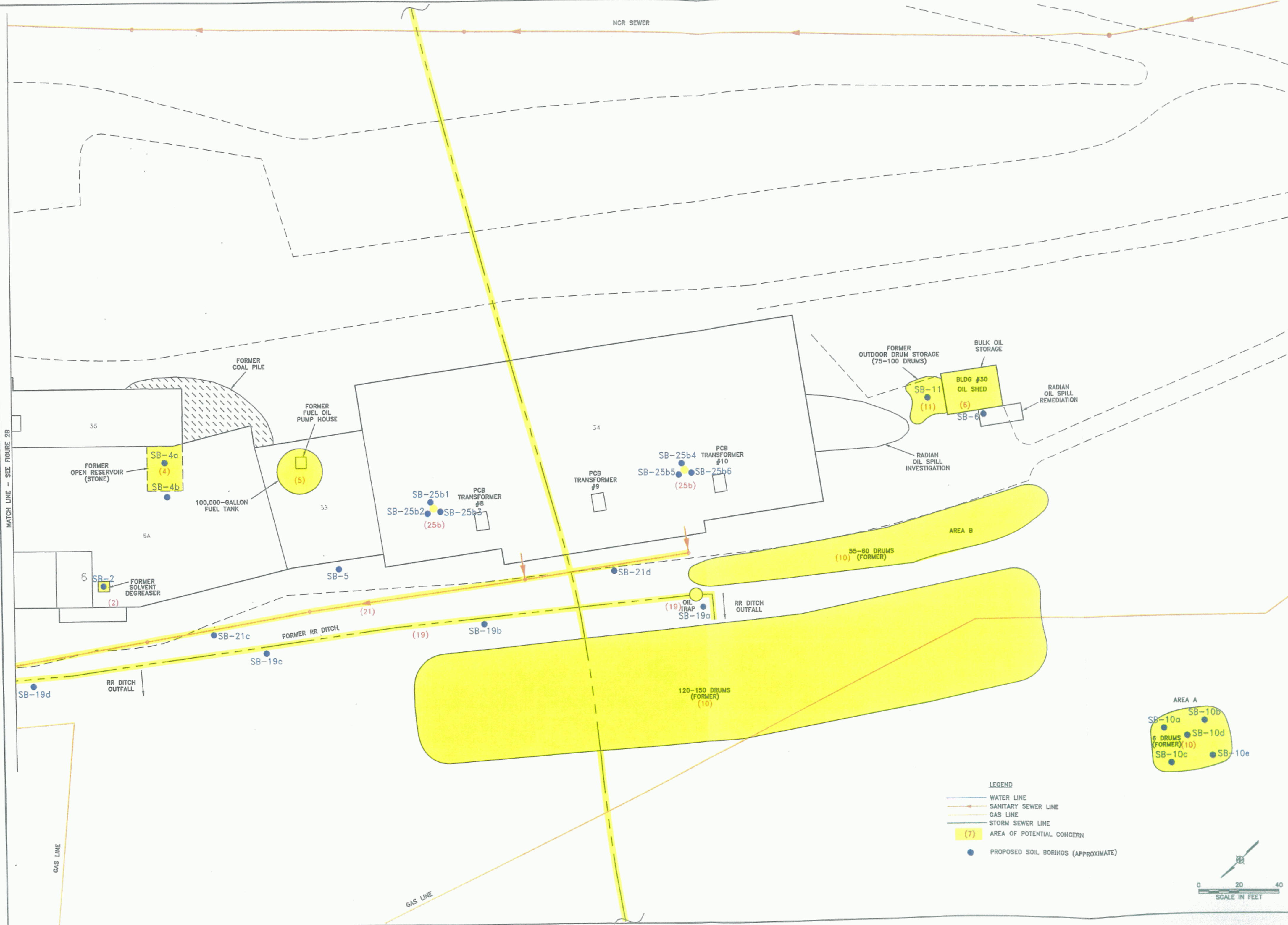

MATCH LINE - SEE FIGURE 2B

REVISIONS	
REV	DESCRIPTION

DRAWN BY	EGC	CHECKED	APPROVED	DATE

WSP ENVIRONMENTAL STRATEGIES LLC
 PROPERTY OF WSP ENVIRONMENTAL STRATEGIES LLC
 THIS DRAWING IS THE PROPERTY OF WSP ENVIRONMENTAL STRATEGIES LLC
 AND IS NOT TO BE REPRODUCED, COPIED, OR TRANSMITTED IN ANY FORM OR BY ANY MEANS
 WITHOUT THE WRITTEN PERMISSION OF WSP ENVIRONMENTAL STRATEGIES LLC
 WSP ENVIRONMENTAL STRATEGIES LLC
 11911 FREEDOM DRIVE SUITE 900
 RESTON, VIRGINIA 20190
 (703) 709-6500

AREAS OF POTENTIAL CONCERN (WESTERN)
 EMERSON POWER TRANSMISSION
 ITHACA, NEW YORK
 PREPARED FOR
 EMERSON POWER TRANSMISSION

FIGURE 2B
 Drawing Number
 127491139